



22 & 23
Lambourne Road

23

RICHMONDS

Lambourne Road, West End, Southampton, SO18 3LS

£195,000

This well presented one-bedroom house is ideally suited to first-time buyers or investors alike and is located in the ever-popular West End area.

The property offers a bright and comfortable living space, complemented by a modern fitted kitchen and a well-appointed bathroom. Upstairs, the bedroom is of a well-proportioned size, providing a peaceful and practical retreat.

Externally, the home benefits from both front and rear gardens, offering valuable outdoor space, along with the added convenience of off-road parking.

Situated close to local amenities and transport links, this property represents an excellent opportunity for those looking to step onto the property ladder or expand their investment portfolio. Early viewing is highly recommended.

Other Information

Tenure: Freehold

Approximate Age: 1980's

Heating: Gas central heating

Windows: Double glazing

Loft: Not inspected

Energy Rating: TBC

Sellers Position: No onward chain

Local Information:

Council Tax: B

Local Authority: Eastleigh Borough Council



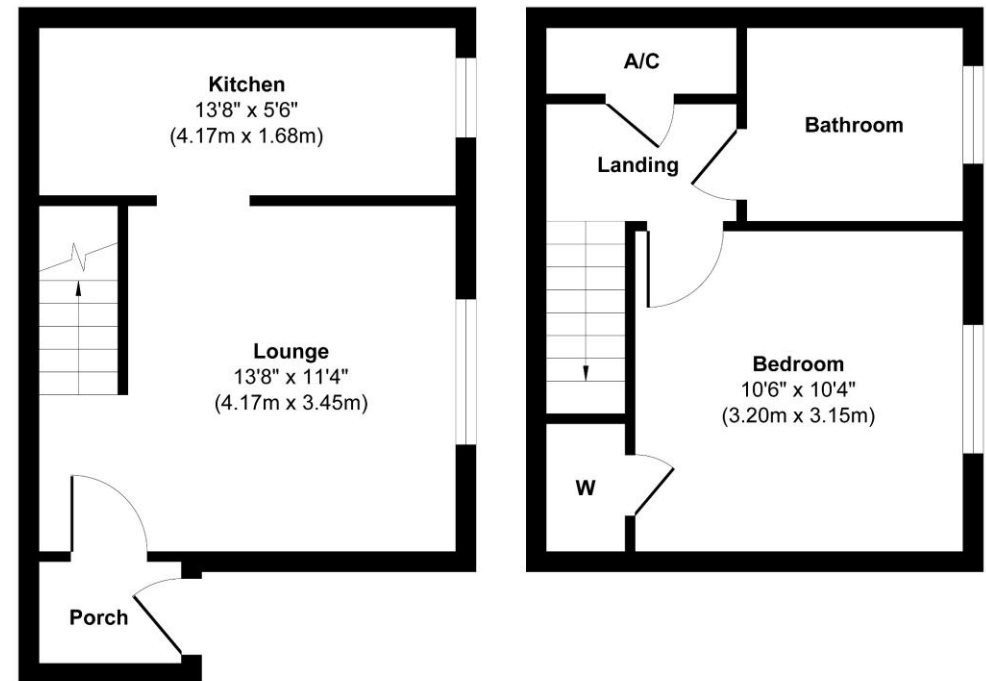

Ground Floor
Approximate Floor Area
251 sq. ft
(23.31 sq. m)

First Floor
Approximate Floor Area
234 sq. ft
(21.73 sq. m)

Approx. Gross Internal Floor Area 485 sq. ft / 45.04 sq. m
Illustration for identification purposes only, measurements are approximate, not to scale.
Produced by Elements Property

Agents Note: The sellers of the property have provided the above information to us and we are therefore reliant on them providing the correct information. The floor plan and sizes are to be used as a guide only. Please check room sizes prior to ordering carpets or furniture. If you require confirmation on any particular point for specific purposes please contact our office for further information. If you have other questions about this property, please telephone **01489 789933**

R545 Ravensworth 01670 713330

Lankester House, 1 Freegrounds Road, Hedge End, Southampton SO30 OHG • 01489 789933 • admin@richmondsproperty.co.uk

